

PROJECT

CATALOG #

TYPE

UV & Far Red Spectras

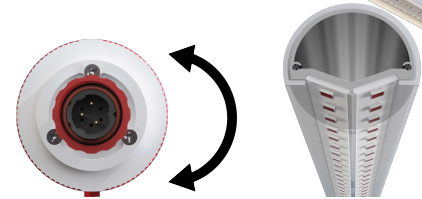
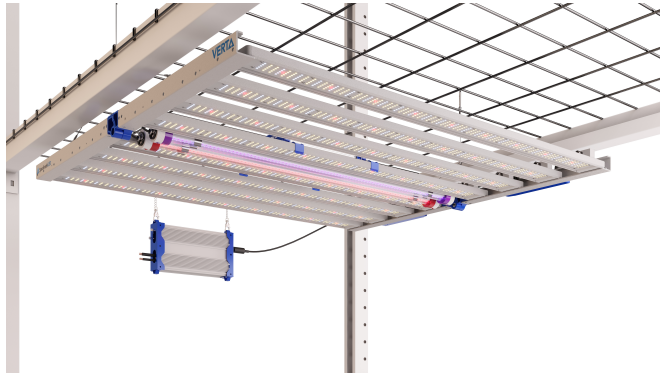

Rotatable 360°
(30° Increments)

150° Beam

PRECISION

The Rotatable Functionality Allows for Delivering Photons with Uniformity and Precision



ENGINEERING

Proprietary Thermal Management System Radiates Less Heat

Ordering Information

EXAMPLE PART #: SUP - 15 - 400 - V01 - VDIM

SUP	15	400	V01	VDIM
SERIES	WATTAGE	WAVELENGTH	INPUT VOLTAGE	CONTROL TYPE
SUP	15	400 730	V01 (120-277V)	VDIM (0-10V)

Available Spectrum

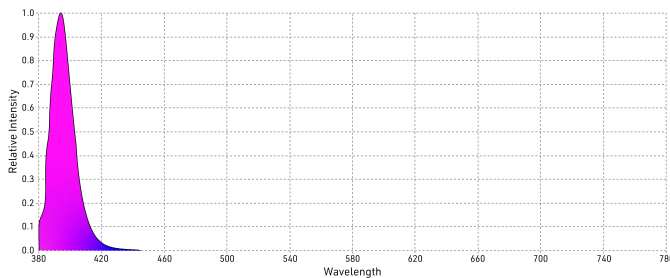

400nm | UVA

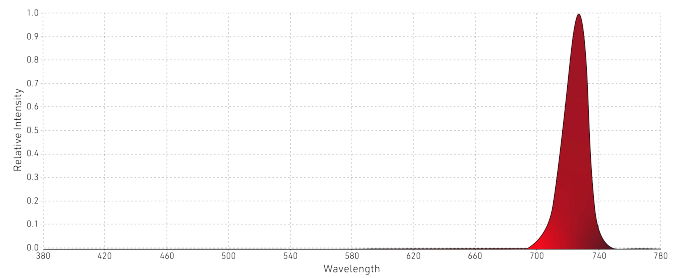

730nm | Far Red

Mounting Options

CR | Clip Ring Installation (Included Standard)



SM | Surface Mounted Installation (Optional Accessory)

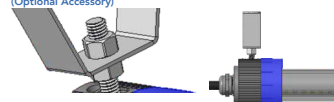

SI | Suspended Installation (Optional Accessory)



Supplemental Wavelength Lighting

Specifications

Performance

System Power | 15W
Optic | 150° Distribution
Wavelength | 400nm, 730nm
Thermal | 100% Passive
Expected Life | L90 > 50000 hrs.

Electrical

Voltage | 120-277VAC (V01)
Dimming | 0-10V
Power Factor | >0.95
Total Harmonic Distortion (THDi) | <12
Driver | Integral

Materials

LEDs | Narrow Band LED Diodes
Material | Polycarbonate
Heat Sink | AL6061

Warranty

LEDs & Drivers | 5 Years

Listings

Ingress Rating | IP66
Impact Rating | IK10
NEMA Rating | NEMA 4X
FCC Compliance | Compliant to 47 CFR FCC Part 15 Subpart B

Misc

Weight | 1.5 lbs ea.
Dimensions | 1.75" X 42"
Finish | Dark Red/White, Violet/White
Mounting | Clip Ring (std.), Surface (opt.), Suspension (opt.)
Rotation Range | 360-Degrees in 30-Degree Increments
Flicker Free
Daisy-Chain-able

Product Data

DIMENSIONS

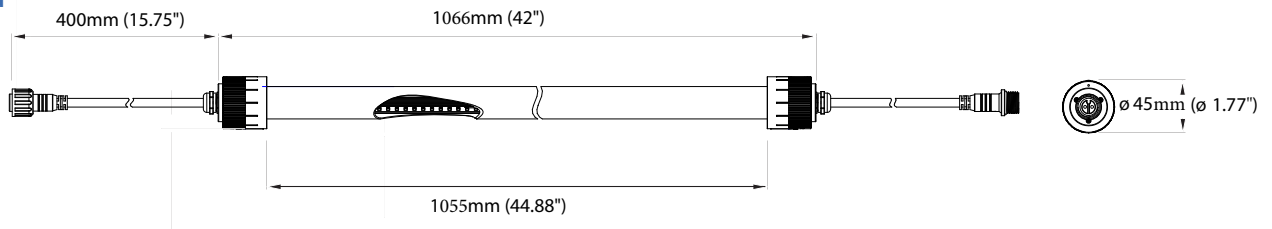

MAXIMUM AMPERAGE BY VOLTAGE SERVICE

Voltage	120V	208V	240V	277V
Amperage	0.125	0.07	0.06	0.055

LAYOUT EXAMPLE

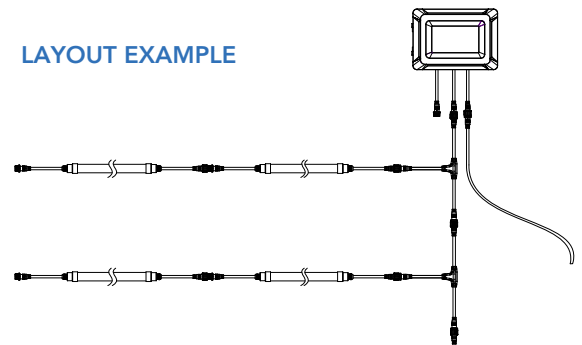

Control (optional)



Month	Day	Year	Start	Min	Light Level	Ramp Minutes
1	1	7	1	45	50	15
2	1	7	10	45	100	15
3	1	7	23	0	0	15
4	8	52	6	45	65	15
5	8	52	10	45	10	15
6	8	52	23	0	0	15
7	0	0	0	0	0	0
8	0	0	0	0	0	0
9	0	0	0	0	0	0
10	0	0	0	0	0	0