

# THE WEDGE

## LED FLOOD LIGHT

450W, 650W, 950W, 1250W, 1850W & 2450W  
REPLACES UP TO A 4000-WATT METAL HALIDE FIXTURE



WGE Shown With Optional SFW Slipfitter

- Low EPA
- Multiple Lumen Packages
- Field Aimable
- Superior Optics for Spill Light Control
- Industry-Leading 10-Year LED Warranty
- Control System Compatibility



### POWER

Available from 450W up to  
2450W Configurations

### PRECISION

Five Custom-Engineered Optics that Offer  
Precisely Directed Light

### ENGINEERING

Advanced Double Folded Aluminum Fins  
Deliver Maximum Thermal Management

### ORDERING INFORMATION

EXAMPLE PART #: WGE - 450 - 40K - 15 - V01 - BL - TMR - VDIM - 80C

WGE									
SERIES	WATTS	CCT	OPTICS	INPUT PWR	FINISH	MOUNTING		DIMMING	OPTIONS
WGE	450	40K	15	V01   120V/277V	BL	TMR   Trunnion (Remote Driver)		NDIM   No Dimming	SP-10   Surge Protector 10kA
	650	50K	30	V04   347V/480V	BZ	TMI   Trunnion (Integrated Driver)		VDIM   0-10V Dimmable	SP-20   Surge Protector 20kA
	950	57K	60		WT	PM   Dual Pendant (Remote Driver Only - Up to 1250W)		DDIM   DALI Dimming	NAT   Natatorium
	1250		90		RAL				90C   90 CRI
	1850		FT						80C   80 CRI
	2450								SFW   Slipfitter for 2-3/8" Tennon

#### NOTES

- Remote Driver Standard; Distance from Luminaire May Not Exceed 100'.
- Standard Remote Driver Distance from Luminaire is 15' unless Otherwise Specified.
- 70 CRI Standard
- Custom RAL Colors Require Additional Costs & Lead Times

### OPTICS

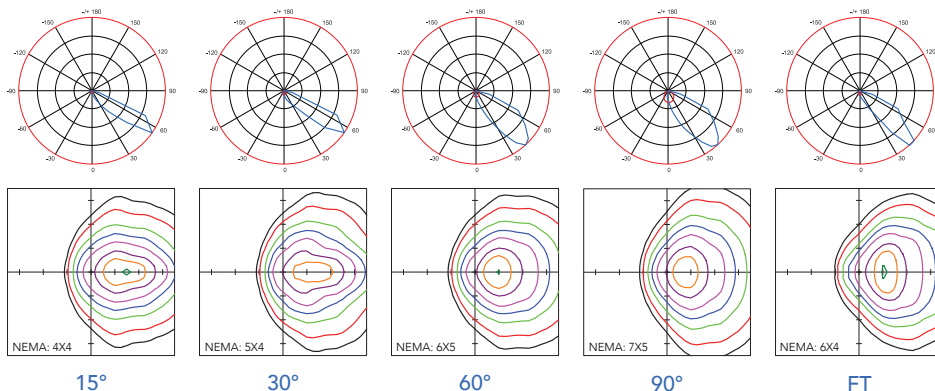

- Fixture: WGE-1250 @ 4000K
- Mounting Height: 60ft
- Grid Scale: 1=50ft

### LUMEN CHART

	4000K	5000K	5700K
450W	49,400 lm	49,400 lm	49,400 lm
650W	70,900 lm	70,900 lm	70,900 lm
950W	102,600 lm	102,600 lm	102,600 lm
1250W	137,300 lm	137,300 lm	137,300 lm
1850W	205,300 lm	205,300 lm	205,300 lm
2450W	274,700 lm	274,700 lm	274,700 lm

Typical delivered lumen data is approximate. Actual lumens will vary due to installation environment and beam pattern. Please see IES files.

# THE WEDGE

## LED FLOOD LIGHT



### SPECIFICATIONS

**Expected Life** | Over 100,000 hrs.  
**Rating** | IP65 & IP66  
**Color Rendering Index (CRI)** | >70  
**Operating Temp** | -40°C – +45°C  
**Relative Humidity** | 0-90% RH  
**Power Factor** | >95%  
**Input Line Voltage** | 90-305 / 200-525 VAC  
**Input Line Frequency** | 50/60 Hz  
**THD** | <20%  
**LED Chips** | Lumileds  
**Driver** | Inventronics  
**Weight & EPA** | See Chart

### LISTINGS

**UL** | 1598  
**UL Surge Protection** | 1449 ETL  
**Listed**  
**DLC** | QPL Listed

### MATERIALS

**Housing** | Corrosion Resistant Aluminum  
**Gasketing** | Neoprene Rubber  
**Hardware** | 18-8 Stainless Steel  
**Finish** | Protective UV Stabilized Powdercoat  
**Lens** | Tempered Glass  
**4000 Hour Salt Spray Tested to ASTM B117**

### EPA & WEIGHT

	EPA	Housing Wt.	Driver Box Wt.
450W	1.2	32.5 lbs.	6.5 lbs.
650W	1.5	39.5 lbs.	12.5 lbs.
950W	2.3	54.0 lbs.	20.0 lbs.
1250W	3.3	68.5 lbs.	25.0 lbs.
1850W	4.6	108.0 lbs.	40.0 lbs.
2450W	6.6	143.5 lbs.	49.5 lbs.

### PRODUCT DRAWINGS

450W - 1250W: Remote Driver

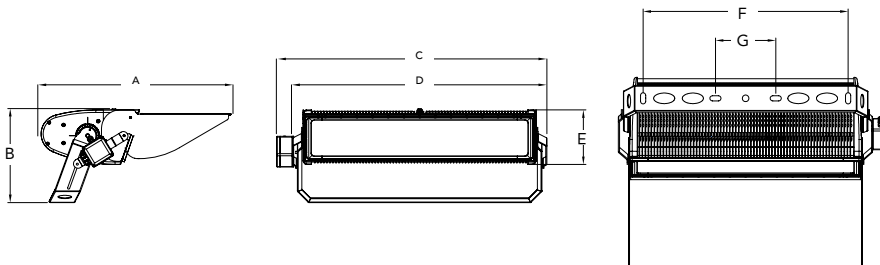

WEDGE DIMENSIONS						
	450W	650W	950W	1250W	1850W	2450W
A	24.75"	24.75"	24.75"	24.75"	H	37.0"
B	12.25"	12.25"	12.25"	12.25"	I	24.75"
C	21.0"	26"	35.25"	45"	J	24.75"
D	18.75"	24"	33"	43"	K	12.25"
E	7"	7"	7"	7"	L	36"
F	12.50"	17.75"	26.75"	36.25"	M	30.5"
G	7.75"	7.75"	7.75"	7.75"	N	7.0"
					P	16.5"
					Q	23.75"

1850W - 2450W: Remote Driver

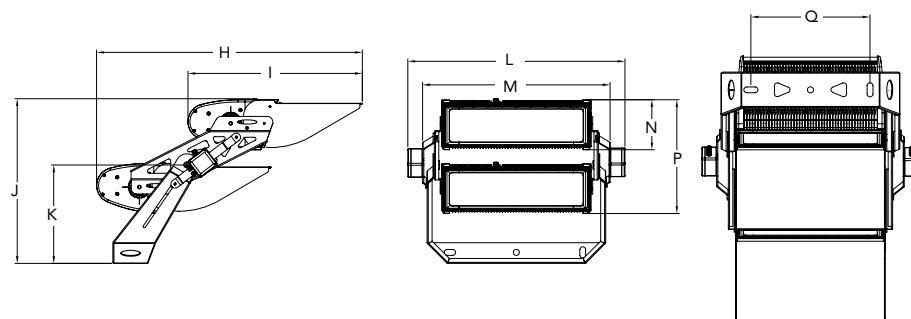

Remote Driver Box A

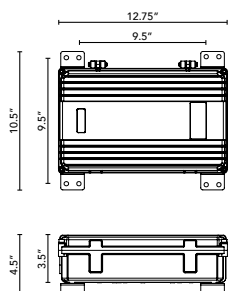

Remote Driver Box B

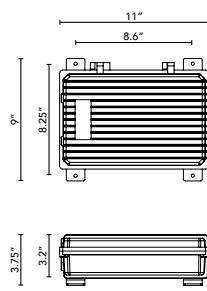

Remote Driver Chart

	Quantity	Driver Box
450W	2	B
650W	1	A
950W	1 & 1	A & B
1250W	2	A
1850W	2 & 2	A & B
2450W	4	A

- Distance from Luminaire May Not Exceed 100'.  
Standard Remote Driver Distance from Luminaire is 15'  
unless Otherwise Specified.

Due to continuous improvement and innovation, product appearance and specifications may change without notice. Actual performance may differ as a result of end-user environment and application.

TOLL-FREE: 888-410-5337 | FAX: 614-868-5344 | © 2022 SpecGradeLED

[www.SpecGradeLED.com](http://www.SpecGradeLED.com)

# THE WEDGE

## LED FLOOD LIGHT

### PRODUCT DRAWINGS

450W: Trunnion Mounted Driver

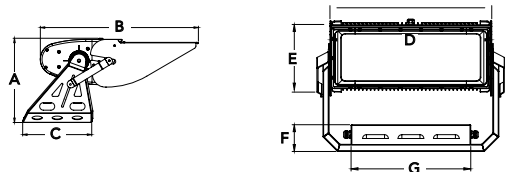

650W: Trunnion Mounted Driver

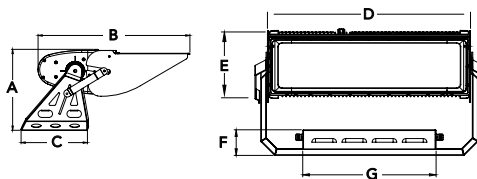

950W: Trunnion Mounted Driver

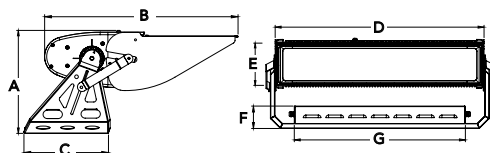

1250W: Trunnion Mounted Driver

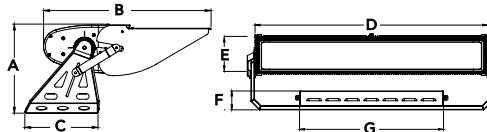

1850W: Trunnion Mounted Driver

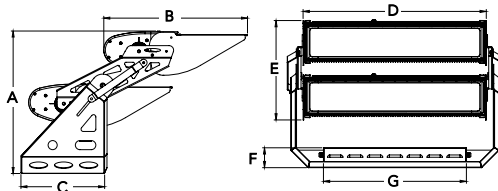

2450W: Trunnion Mounted Driver

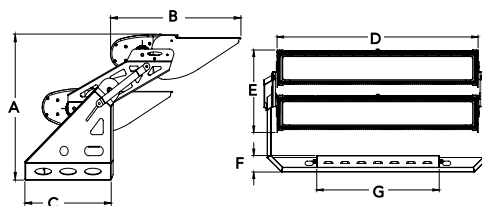

WEDGE DIMENSIONS WITH DRIVER						
	450W	650W	950W	1250W	1850W	2450W
A	13.25"	13.25"	13.25"	13.25"	24.75"	24.75"
B	24.75"	24.75"	24.75"	24.75"	24.75"	24.75"
C	10.75"	10.75"	10.75"	10.75"	14.50"	14.50"
D	16.25"	24.0"	33.25"	43.0"	30.50"	45.75"
E	7.0"	7.0"	7.0"	7.0"	16.50"	16.50"
F	2.75"	2.75"	3.25"	3.25"	3.25"	3.25"
G	12.0"	14.0"	25.0"	25.0"	23.75"	23.75"

450W - 1250W: Dual Pendant Mount

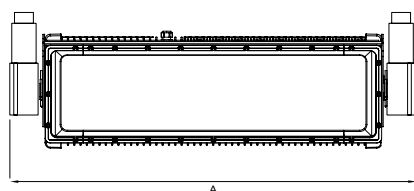

WEDGE DIMENSIONS WITH PENDANT MOUNT				
	450W	650W	950W	1250W
A	24"	29"	38.25"	48"