

THE WEDGE

LED FLOOD LIGHT

450W, 650W, 950W, 1250W, 1850W & 2450W
REPLACES UP TO A 4000-WATT METAL HALIDE FIXTURE



WGE Shown With Optional SFW Slipfitter

- Low EPA
- Multiple Lumen Packages
- Field Aimable
- Superior Optics for Spill Light Control
- Industry-Leading 10-Year LED Warranty
- Control System Compatibility



POWER

Available from 450W up to 2450W Configurations

PRECISION

Five Custom-Engineered Optics that Offer Precisely Directed Light

ENGINEERING

Advanced Double Folded Aluminum Fins Deliver Maximum Thermal Management

ORDERING INFORMATION

EXAMPLE PART #: WGE - 450 - 40K - 15 - V01 - BL - TMR - VDIM - 80C

WGE									
SERIES	WATTS	CCT	OPTICS	INPUT PWR	FINISH	MOUNTING	DIMMING	OPTIONS	
WGE	450	40K	15	V01 120V/277V	BL	TMR Trunnion (Remote Driver)	NDIM No Dimming	SP-10 Surge Protector 10kA	
	650	50K	30	V04 347V/480V	BZ	TMI Trunnion (Integrated Driver)	VDIM 0-10V Dimmable	SP-20 Surge Protector 20kA	
	950	57K	60		WT	PM Dual Pendant (Remote Driver Only - Up to 1250W)	DDIM DALI Dimming	NAT Natatorium	
	1250		90		RAL			90C 90 CRI	
	1850		FT					80C 80 CRI	
2450								SFW Slipfitter for 2-3/8" Tennon	
								SYN Synapse Wireless	

NOTES

- Remote Driver Standard; Distance from Luminaire May Not Exceed 100'.
- Standard Remote Driver Distance from Luminaire is 15' unless Otherwise Specified.
- 70 CRI Standard
- Custom RAL Colors Require Additional Costs & Lead Times

OPTICS

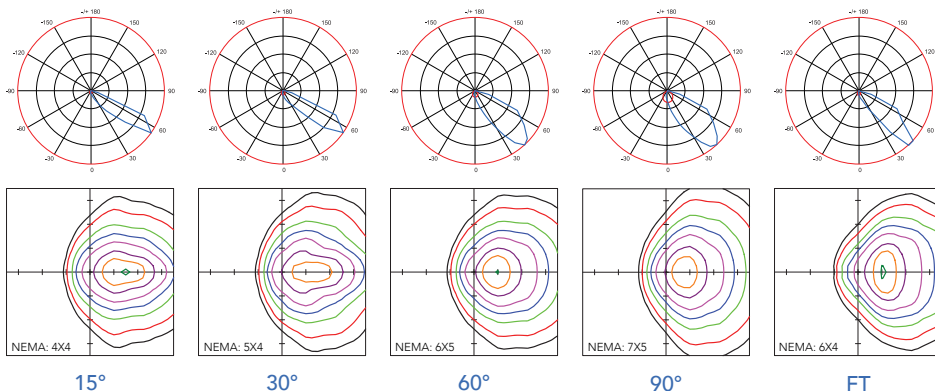

- Fixture: WGE-1250 @ 4000K
- Mounting Height: 60ft
- Grid Scale: 1=50ft

LUMEN CHART

	4000K	5000K	5700K
450W	49,400 lm	49,400 lm	49,400 lm
650W	70,900 lm	70,900 lm	70,900 lm
950W	102,600 lm	102,600 lm	102,600 lm
1250W	137,300 lm	137,300 lm	137,300 lm
1850W	205,300 lm	205,300 lm	205,300 lm
2450W	274,700 lm	274,700 lm	274,700 lm

Typical delivered lumen data is approximate. Actual lumens will vary due to installation environment and beam pattern. Please see IES files.

THE WEDGE

LED FLOOD LIGHT

SPECIFICATIONS

Expected Life | Over 100,000 hrs.
Rating | IP65 & IP66
Color Rendering Index (CRI) | >70
Operating Temp | -40°C – +45°C
Relative Humidity | 0-90% RH
Power Factor | >95%
Input Line Voltage | 90-305 / 200-525 VAC
Input Line Frequency | 50/60 Hz
THD | <20%
LED Chips | Lumileds
Driver | Inventronics
Weight & EPA | See Chart

LISTINGS

UL | 1598
UL Surge Protection | 1449 ETL Listed
DLC | QPL Listed

MATERIALS

Housing | Corrosion Resistant Aluminum
Gasketing | Neoprene Rubber
Hardware | 18-8 Stainless Steel
Finish | Protective UV Stabilized Powdercoat
Lens | Tempered Glass
4000 Hour Salt Spray Tested to ASTM B117

EPA & WEIGHT

	EPA	Housing Wt.	Driver Box Wt.
450W	1.2	32.5 lbs.	6.5 lbs.
650W	1.5	39.5 lbs.	12.5 lbs.
950W	2.3	54.0 lbs.	20.0 lbs.
1250W	3.3	68.5 lbs.	25.0 lbs.
1850W	4.6	108.0 lbs.	40.0 lbs.
2450W	6.6	143.5 lbs.	49.5 lbs.

PRODUCT DRAWINGS

450W - 1250W: Remote Driver

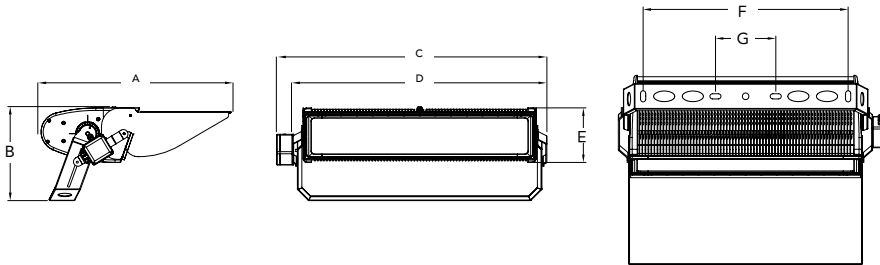

WEDGE DIMENSIONS							
	450W	650W	950W	1250W		1850W	2450W
A	24.75"	24.75"	24.75"	24.75"	H	37.0"	37.0"
B	12.25"	12.25"	12.25"	12.25"	I	24.75"	24.75"
C	21.0"	26"	35.25"	45"	J	24.75"	24.75"
D	18.75"	24"	33"	43"	K	12.25"	12.25"
E	7"	7"	7"	7"	L	36"	45.50"
F	12.50"	17.75"	26.75"	36.25"	M	30.5"	40.5"
G	7.75"	7.75"	7.75"	7.75"	N	7.0"	7.0"
					P	16.5"	16.5"
					Q	23.75"	24.5"

1850W - 2450W: Remote Driver

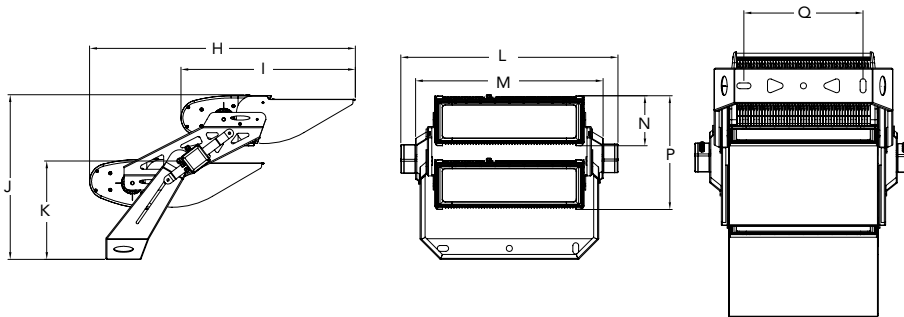

Remote Driver Box A

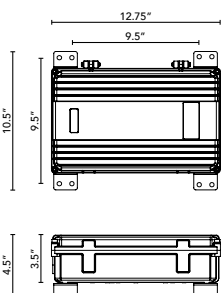

Remote Driver Box B

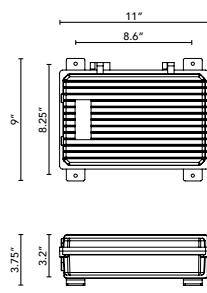

Remote Driver Chart

	Quantity	Driver Box
450W	2	B
650W	1	A
950W	1 & 1	A & B
1250W	2	A
1850W	2 & 2	A & B
2450W	4	A

- Distance from Luminaire May Not Exceed 100'. Standard Remote Driver Distance from Luminaire is 15' unless Otherwise Specified.

THE WEDGE

LED FLOOD LIGHT



PRODUCT DRAWINGS

450W: Trunnion Mounted Driver

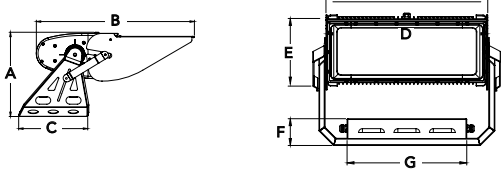

650W: Trunnion Mounted Driver

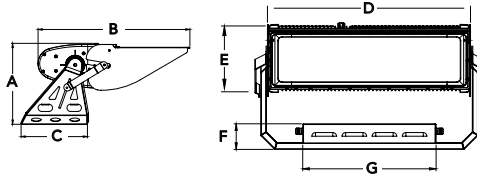

950W: Trunnion Mounted Driver

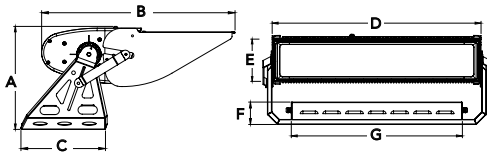

1250W: Trunnion Mounted Driver

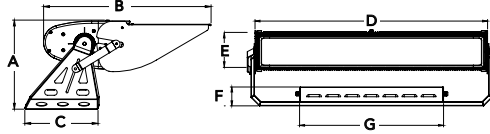

1850W: Trunnion Mounted Driver

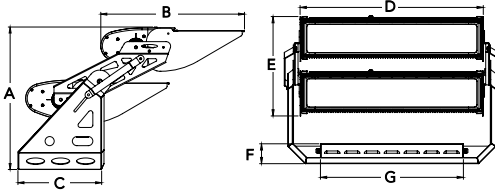

2450W: Trunnion Mounted Driver

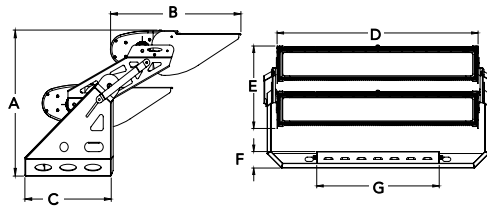

WEDGE DIMENSIONS WITH DRIVER

	450W	650W	950W	1250W	1850W	2450W
A	13.25"	13.25"	13.25"	13.25"	24.75"	24.75"
B	24.75"	24.75"	24.75"	24.75"	24.75"	24.75"
C	10.75"	10.75"	10.75"	10.75"	14.50"	14.50"
D	16.25"	24.0"	33.25"	43.0"	30.50"	45.75"
E	7.0"	7.0"	7.0"	7.0"	16.50"	16.50"
F	2.75"	2.75"	3.25"	3.25"	3.25"	3.25"
G	12.0"	14.0"	25.0"	25.0"	23.75"	23.75"

450W - 1250W: Dual Pendant Mount

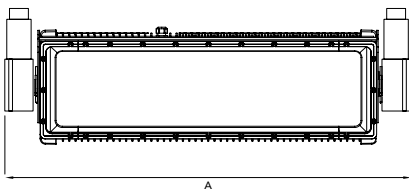

WEDGE DIMENSIONS WITH PENDANT MOUNT

	450W	650W	950W	1250W
A	24"	29"	38.25"	48"

Due to continuous improvement and innovation, product appearance and specifications may change without notice. Actual performance may differ as a result of end-user environment and application.

TOLL-FREE: 888-410-5337 | FAX: 614-868-5344 | © 2026 SpecGrade

www.SpecGrade.com